

## 57 Mountain View Drive Goonellabah

### Table of Contents

- | [Property Details](#)
- | [Photo Gallery](#)
- | [Map](#)
- | [Contact For Inspection](#)

## Property Details

57 Mountain View Drive, Goonellabah



NORTHERN RIDGE - EXPANSIVE VIEWS

4  2  2 

Elevated on the desirable Northern Ridge, this solid 4-bedroom, 2-bathroom brick and tile home offers breathtaking panoramic valley views with a versatile family friendly layout. Stunning blackbutt timber floors, modern finishes and multiple outdoor spaces, this spacious home provides the perfect blend of style and functionality.

- ◆ 4 bedrooms ◆ all with built-in-robos, ceiling fans plus main with ensuite, walk-in robe and air-conditioning
- ◆ Spacious living with separate lounge, dining and family areas with air-conditioning, giving comfort all year round
- ◆ Stylish, modern kitchen with stone benchtops, gas cooking plus dishwasher
- ◆ Covered outdoor timber deck with expansive views to the hills and valleys, catching the cool summer breezes
- ◆ Fenced backyard with established gardens and paved outdoor patio
- ◆ Large modern bathroom with shower and corner bath plus separate toilet
  
- ◆ Solar power system (12 panels) & solar hot water to reduce the electricity bills
- ◆ Handy location, within 6 mins drive from Lismore Shopping Square, GSAC, sports fields, schools, parks and so much more

This lovely home offers something for the whole family to enjoy. Call today to arrange your inspection.

---

**\$769,000**

- 4 Bedrooms
- 2 Bathrooms
- 2 Garages
- 1 Ensuite
- Air Conditioning
- Remote Garage
- Deck
- Floor boards
- Fully Fenced
- Built In Robes
- Dishwasher

## Photo Gallery





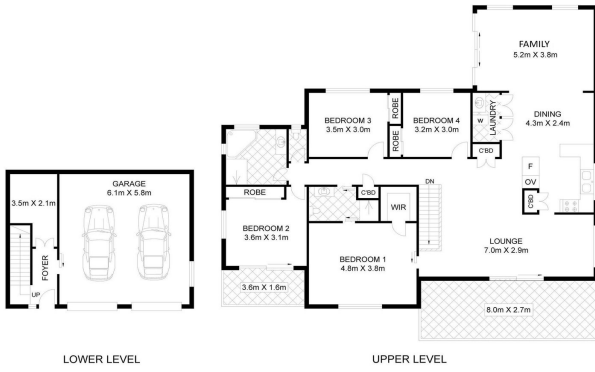

LOWER LEVEL

UPPER LEVEL

0 1 2 3 4 5

Scale in meters, indicative only. Dimensions are approximate. All information contained herein gathered from sources we believe to be reliable. However we cannot guarantee its accuracy and interested persons should rely on their own enquiries.

INT : 159.40m<sup>2</sup>  
EXT : 28.90m<sup>2</sup>  
GARAGE : 48.80m<sup>2</sup>



**57 Mountain View Dr, Goonellabah**

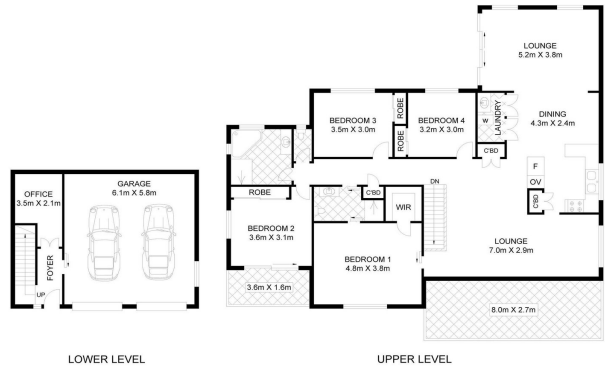

LOWER LEVEL

UPPER LEVEL

0 1 2 3 4 5

Scale in meters, indicative only. Dimensions are approximate. All information contained herein gathered from sources we believe to be reliable. However we cannot guarantee its accuracy and interested persons should rely on their own enquiries.

INT : 159.40m<sup>2</sup>  
EXT : 28.90m<sup>2</sup>  
GARAGE : 48.80m<sup>2</sup>



**57 Mountain View Dr, Goonellabah**

## Map

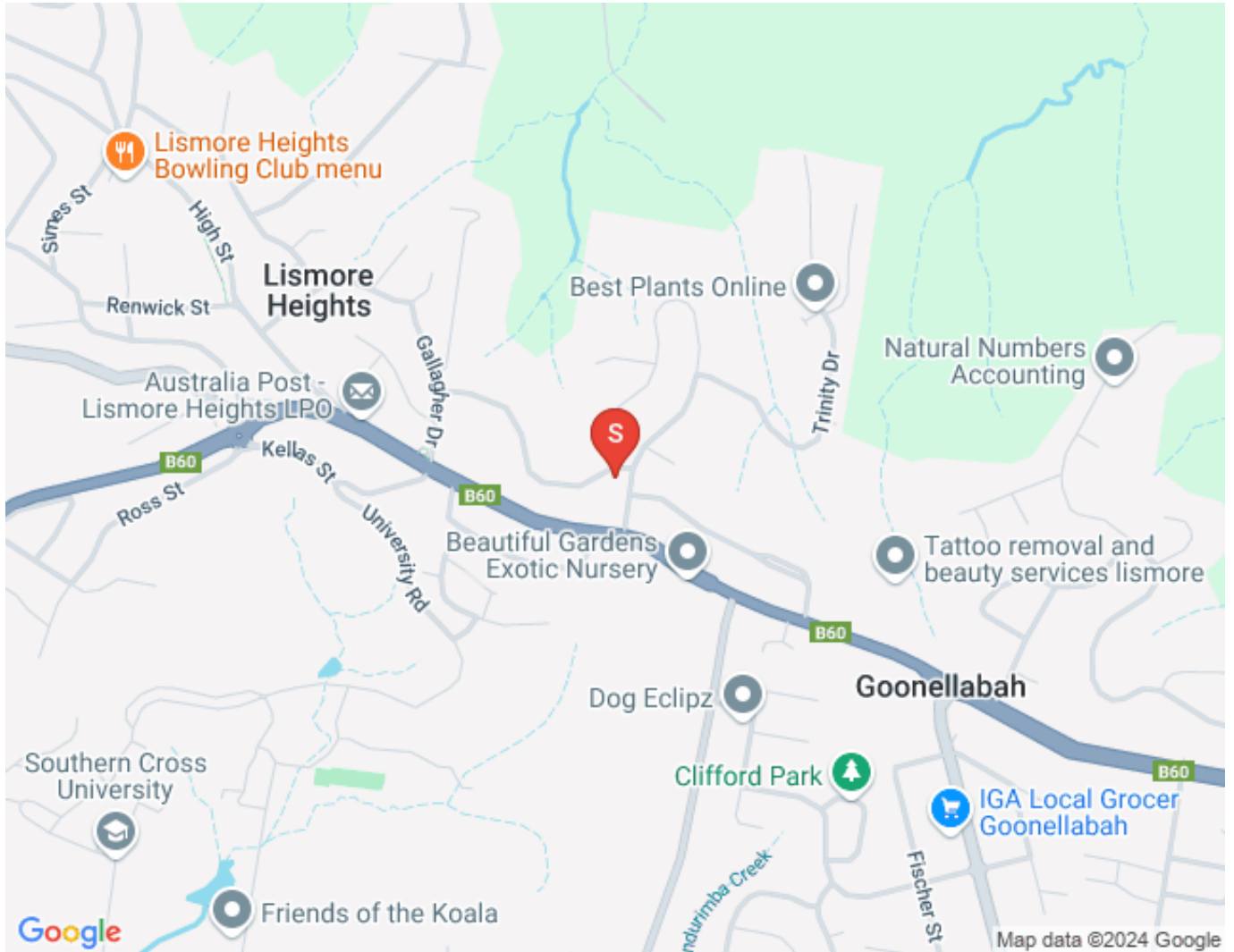

## Contact For Inspection



### **BENJAMIN CONTE**

LICENSED REAL ESTATE AGENT

---

0408 368 913

[ben@walmurray.com.au](mailto:ben@walmurray.com.au)